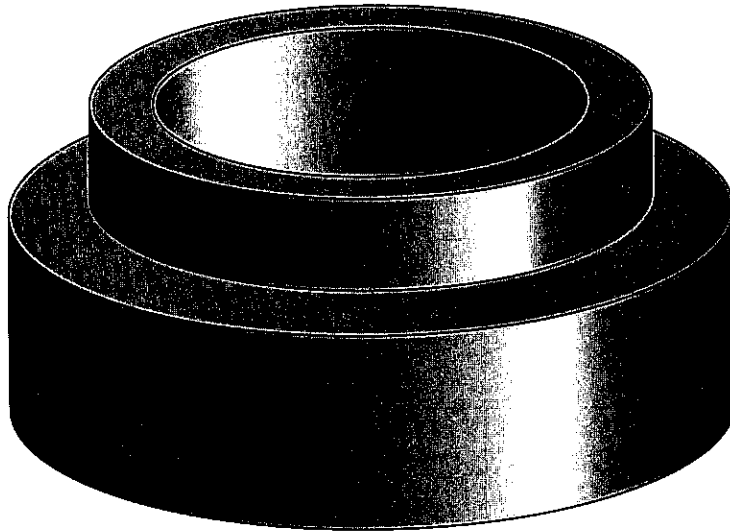

TABLE OF CONTENTS

SHOULDER WASHERS



MATERIAL TYPE	PAGE NO.
EPOXY GLASS	124
FIBRE	127
PCTFE	130
NYLON	131
PHENOLIC	138
TEFLON	140

FOR MATERIAL INFORMATION, SEE ENGINEERING
TABLES BEGINNING ON PAGE 543.

- Solder Lugs
- Spring Clips
- Spring Washers
- Shoulder Washers**
- Stand Off Spacers
- Flat Round Washers – Metallic
- Flat Round Washers – Non-Metallic
- O-Rings
- Retaining Rings
- Lockwashers, Retention Washers & Push-on Nuts
- Clamps & Brackets
- Expansion Plugs
- Ground Straps, Bus Bars & Term. Blocks
- Tab & Notch Washers
- Misc. Washers & Tags
- Solid State Insulators
- Military Standards
- Custom Parts
- Engineering Tables
- Num. & Alpha. Index of Parts

EPOXY GLASS (GEE) SHOULDER WASHER

Custom Sizes Available ... See Last Page of This Section

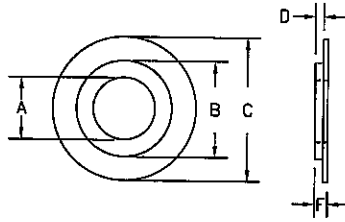

PART NUMBER	SCREW SIZE	A ± .005	B ± .010	C ± .010	D ± .005	F ± .015
5603-1	00	.062	.127	.189	.023	.067
5603-2	2	.090	.154	.225	.031	.090
5603-3	2	.090	.156	.250	.031	.062
5603-4	2	.093	.123	.218	.035	.070
5603-5	2	.095	.156	.250	.120	.156
5603-6	2	.099	.186	.250	.015	.097
5603-7	2	.100	.187	.250	.015	.064
5603-8	3	.103	.191	.312	.030	.060
5603-9	3	.104	.218	.437	.016	.078
5603-10	3	.106	.155	.255	.078	.112
5603-11	3	.110	.187	.250	.031	.062
5603-12	4	.114	.150	.312	.100	.145
5603-13	4	.115	.145	.314	.090	.160
5603-14	4	.115	.195	.265	.032	.064
5603-15	4	.116	.140	.250	.187	.233
5603-16	4	.117	.137	.250	.035	.095
5603-17	4	.117	.146	.250	.050	.092
5603-18	4	.117	.150	.313	.150	.200
5603-19	4	.117	.150	.313	.280	.330
5603-20	4	.120	.187	.250	.120	.152
5603-21	4	.120	.187	.312	.050	.112
5603-22	4	.120	.187	.312	.080	.112
5603-23	4	.120	.187	.312	.100	.162
5603-24	4	.120	.187	.312	.131	.162
5603-25	4	.125	.180	.625	.030	.060
5603-26	4	.125	.185	.296	.131	.162
5603-27	4	.125	.195	.310	.031	.062
5603-28	4	.125	.195	.310	.063	.094
5603-29	4	.125	.195	.310	.125	.156
5603-30	4	.125	.203	.281	.032	.062
5603-31	4	.125	.218	.375	.030	.060
5603-32	5	.128	.186	.265	.030	.060
5603-33	5	.128	.186	.312	.031	.061
5603-34	5	.128	.186	.312	.033	.090
5603-35	5	.128	.210	.420	.030	.060
5603-36	5	.133	.240	.450	.030	.090
5603-37	5	.136	.187	.250	.031	.062
5603-38	5	.136	.187	.250	.031	.093
5603-39	5	.136	.187	.312	.034	.062
5603-40	5	.136	.187	.312	.062	.093

EPOXY GLASS (GEE) SHOULDER WASHER (Continued)

Custom Sizes Available . . . See Last Page of This Section

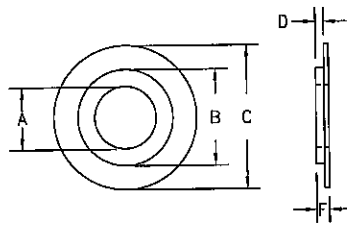

PART NUMBER	SCREW SIZE	A ± .005	B ± .010	C ± .010	D ± .005	F ± .015
5603-41	5	.139	.214	.312	.027	.060
5603-42	5	.140	.187	.312	.031	.062
5603-43	5	.140	.200	.328	.030	.079
5603-44	5	.140	.200	.375	.060	.109
5603-45	5	.140	.210	.375	.032	.094
5603-46	5	.140	.232	.375	.030	.090
5603-47	5	.140	.250	.375	.030	.060
5603-48	6	.141	.182	.312	.030	.078
5603-49	6	.141	.182	.320	.105	.174
5603-50	6	.141	.278	.437	.030	.060
5603-51	6	.144	.182	.322	.035	.095
5603-52	6	.145	.190	.312	.120	.152
5603-53	6	.146	.182	.312	.031	.078
5603-54	6	.146	.187	.312	.050	.112
5603-55	6	.146	.187	.312	.100	.162
5603-56	6	.146	.237	.375	.050	.112
5603-57	6	.146	.237	.375	.100	.162
5603-58	6	.146	.237	.375	.031	.162
5603-59	6	.147	.207	.319	.031	.062
5603-60	6	.150	.200	.375	.018	.046
5603-61	6	.152	.230	.340	.031	.062
5603-62	6	.152	.230	.340	.063	.094
5603-63	6	.152	.230	.340	.125	.156
5603-64	6	.156	.234	.375	.045	.091
5603-65	6	.156	.250	.375	.030	.060
5603-66	6	.156	.250	.375	.040	.087
5603-67	6	.156	.250	.437	.030	.060
5603-68	6	.164	.229	.312	.050	.089
5603-69	8	.170	.211	.343	.035	.095
5603-70	8	.170	.250	.375	.031	.093
5603-71	8	.174	.250	.375	.120	.152
5603-72	8	.177	.250	.365	.031	.062
5603-73	8	.177	.250	.365	.063	.094
5603-74	8	.177	.250	.365	.125	.156
5603-75	8	.190	.240	.375	.031	.062
5603-76	8	.190	.240	.500	.032	.093
5603-77	8	.190	.375	.562	.030	.060
5603-78	10	.193	.250	.375	.032	.064
5603-79	10	.196	.255	.438	.032	.064
5603-80	10	.196	.308	.375	.031	.093

Solder Lugs

Spring Clips

Spring Washers

Shoulder Washers

Stand Off Spacers

Flat Round Washers - Metallic

Flat Round Washers - Non-Metallic

O-Rings

Retaining Rings

Lockwashers, Retention Washers & Push-on Nuts

Clamps & Brackets

Expansion Plugs

Ground Straps, Bus Bars & Term. Blocks

Tab & Notch Washers

Misc. Washers & Tags

Solid State Insulators

Military Standards

Custom Parts

Engineering Tables

Num. & Alpha. Index of Parts

EPOXY GLASS (GEE) SHOULDER WASHER *(Continued)*

Custom Sizes Available . . . See Last Page of This Section

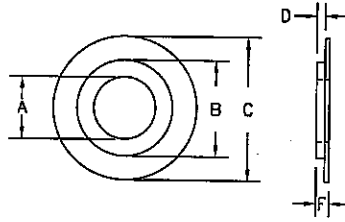

PART NUMBER	SCREW SIZE	A ± .005	B ± .010	C ± .010	D ± .005	F ± .015
5603-81	10	.199	.259	.372	.031	.062
5603-82	10	.199	.259	.372	.062	.093
5603-83	10	.200	.245	.530	.030	.060
5603-84	10	.200	.252	.375	.120	.152
5603-85	10	.200	.303	.375	.020	.060
5603-86	10	.200	.303	.375	.035	.095
5603-87	10	.201	.269	.505	.095	.140
5603-88	10	.203	.250	.438	.032	.063
5603-89	10	.203	.265	.500	.043	.105
5603-90	10	.203	.275	.390	.031	.062
5603-91	10	.203	.275	.390	.063	.094
5603-92	10	.203	.275	.390	.125	.156
5603-93	10	.203	.275	.590	.030	.060
5603-94	10	.203	.282	.437	.030	.060
5603-95	10	.203	.312	.375	.032	.094
5603-96	10	.203	.312	.500	.020	.075
5603-97	10	.206	.440	.625	.031	.093
5603-98		.260	.338	.500	.035	.095
5603-99		.261	.321	.432	.031	.062
5603-100		.261	.321	.432	.062	.093
5603-101		.265	.335	.445	.031	.062
5603-102		.265	.335	.445	.063	.094
5603-103		.265	.335	.445	.125	.156
5603-104		.323	.383	.497	.031	.062
5603-105		.323	.383	.497	.062	.093
5603-106		.328	.400	.510	.031	.062
5603-107		.328	.400	.510	.063	.093
5603-108		.328	.400	.510	.125	.156
5603-109		.332	.500	.750	.030	.060
5603-110		.386	.446	.553	.031	.062
5603-111		.386	.446	.553	.062	.093

FIBRE SHOULDER WASHER

Custom Sizes Available . . . See Last Page of This Section

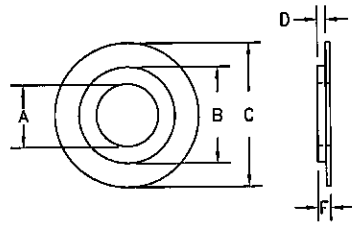

PART NUMBER	SCREW SIZE	A ± .005	B ± .010	C ± .010	D ± .005	F ± .015
5604-3	0	.064	.086	.187	.009	.026
5604-5	0	.064	.086	.187	.025	.045
5604-4	0	.064	.090	.187	.009	.035
5604-6	0	.064	.090	.187	.025	.058
5604-70	0	.064	.120	.187	.025	.068
5604-7	0	.065	.141	.219	.031	.062
5604-1	1	.078	.141	.219	.031	.062
5604-2	2	.090	.156	.250	.031	.062
5604-9	3	.099	.186	.250	.015	.097
5604-8	3	.100	.187	.250	.015	.064
5604-72	3	.103	.191	.312	.030	.060
5604-10	3	.104	.218	.437	.016	.078
5604-41	3	.110	.187	.250	.031	.062
5604-42	4	.115	.195	.265	.032	.064
5604-43	4	.120	.187	.375	.032	.093
5604-44	4	.125	.203	.281	.032	.062
5604-79	4	.125	.218	.375	.030	.060
5604-11	5	.128	.186	.312	.031	.061
5604-45	5	.128	.186	.312	.033	.090
5604-81	5	.128	.210	.420	.030	.060
5604-82	5	.133	.240	.450	.030	.090
5604-83	5	.136	.187	.250	.031	.062
5604-12	5	.136	.187	.250	.031	.093
5604-13	5	.136	.187	.312	.034	.062
5604-84	5	.136	.187	.313	.034	.093
5604-15	5	.139	.214	.312	.027	.060
5604-46	6	.140	.187	.312	.031	.062
5604-47	6	.140	.190	.312	.039	.062
5604-16	6	.140	.200	.328	.030	.079
5604-49	6	.140	.210	.375	.032	.094
5604-50	6	.140	.232	.375	.030	.090
5604-85	6	.140	.250	.375	.030	.060
5604-14	6	.141	.182	.312	.030	.078
5604-51	6	.141	.182	.312	.042	.092
5604-86	6	.141	.278	.437	.030	.060
5604-52	6	.150	.200	.375	.018	.046
5604-114	6	.151	.170	.250	.023	.038
5604-53	6	.156	.234	.375	.045	.091
5604-88	6	.156	.250	.375	.030	.060
5604-89	6	.156	.250	.437	.030	.060

Solder Lugs

Spring Clips

Spring Washers

Shoulder Washers

Stand Off Spacers

Flat Round Washers - Metallic

Flat Round Washers - Non-Metallic

O-Rings

Retaining Rings

Lockwashers, Retention Washers & Push-on Nuts

Clamps & Brackets

Expansion Plugs

Ground Straps, Bus Bars & Term. Blocks

Tab & Notch Washers

Misc. Washers & Tags

Solid State Insulators

Military Standards

Custom Parts

Engineering Tables

Num. & Alpha. Index of Parts

FIBRE SHOULDER WASHER (Continued)

Custom Sizes Available . . . See Last Page of This Section

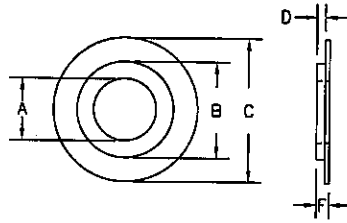

PART NUMBER	SCREW SIZE	A ± .005	B ± .010	C ± .010	D ± .005	F ± .015
5604-17	6	.164	.229	.312	.050	.089
5604-19	8	.170	.250	.375	.031	.093
5604-18	8	.171	.250	.375	.032	.063
5604-91	8	.190	.240	.375	.030	.062
5604-20	8	.190	.240	.500	.032	.093
5604-92	8	.190	.375	.562	.030	.060
5604-21	10	.193	.252	.375	.032	.064
5604-54	10	.196	.255	.438	.032	.062
5604-55	10	.196	.308	.375	.031	.093
5604-56	10	.198	.305	.375	.013	.093
5604-57	10	.200	.245	.530	.030	.070
5604-22	10	.200	.304	.375	.020	.059
5604-23	10	.203	.250	.438	.032	.063
5604-24	10	.203	.265	.500	.043	.105
5604-96	10	.203	.282	.437	.030	.060
5604-58	10	.203	.312	.375	.032	.094
5604-59	10	.203	.312	.500	.020	.075
5604-60	10	.206	.440	.625	.031	.093
5604-115	12	.218	.312	.500	.029	.070
5604-97	12	.220	.312	.375	.032	.064
5604-98	12	.220	.312	.500	.030	.060
5604-25	12	.230	.295	.359	.028	.096
5604-61		.250	.312	.438	.025	.047
5604-62		.250	.312	.500	.032	.093
5604-100		.250	.344	.500	.031	.046
5604-63		.250	.344	.500	.032	.093
5604-64		.250	.375	.500	.031	.062
5604-26		.253	.338	.505	.025	.060
5604-27		.255	.312	.500	.031	.062
5604-116		.257	.375	.500	.035	.060
5604-102		.258	.375	.562	.030	.060
5604-28		.260	.310	.430	.032	.062
5604-29		.265	.365	.500	.031	.093
5604-30		.290	.375	.562	.029	.080
5604-104		.290	.400	.688	.030	.060
5604-39		.313	.375	.437	.020	.045
5604-105		.317	.370	.500	.032	.064
5604-40		.318	.402	.562	.033	.078
5604-65		.375	.437	.625	.016	.045
5604-66		.375	.437	.625	.031	.093

FIBRE SHOULDER WASHER *(Continued)*

Custom Sizes Available . . . See Last Page of This Section

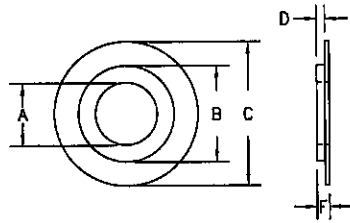

PART NUMBER	SCREW SIZE	A ± .005	B ± .010	C ± .010	D ± .005	F ± .015
5604-107		.375	.500	.625	.031	.078
5604-67		.375	.500	.625	.031	.093
5604-68		.375	.500	.750	.031	.093
5604-31		.377	.437	.625	.029	.063
5604-32		.384	.495	.625	.025	.074
5604-33		.398	.493	.750	.039	.082
5604-34		.413	.500	.750	.030	.060
5604-109		.443	.527	.750	.032	.064
5604-110		.475	.560	.656	.030	.060
5604-36		.500	.750	1.000	.031	.062
5604-37		.500	.750	1.000	.031	.093
5604-111		.505	.590	.750	.032	.064
5604-38		.510	.560	.890	.030	.070

Solder Lugs

Spring Clips

Spring Washers

Shoulder Washers

Stand Off Spacers

Flat Round Washers - Metallic

Flat Round Washers - Non-Metallic

O-Rings

Retaining Rings

Lockwashers, Retention Washers & Push-on Nuts

Clamps & Brackets

Expansion Plugs

Ground Straps, Bus Bars & Term. Blocks

Tab & Notch Washers

Misc. Washers & Tags

Solid State Insulators

Military Standards

Custom Parts

Engineering Tables

Num. & Alpha. Index of Parts

PCTFE SHOULDER WASHER

Custom Sizes Available . . . See Last Page of This Section

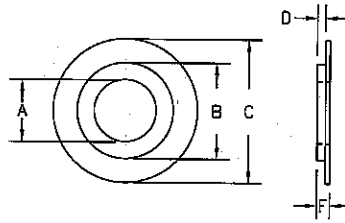

PART NUMBER	SCREW SIZE	A ± .005	B ± .010	C ± .010	D ± .005	F ± .015
5609-4	0	.065	.093	.188	.025	.055
5609-8	2	.097	.189	.250	.014	.068
5609-1	4	.115	.145	.235	.067	.134
5609-6	4	.115	.145	.235	.093	.186
5609-7	4	.121	.143	.250	.040	.093
5609-5	4	.121	.143	.250	.060	.093
5609-11	4	.127	.194	.314	.031	.067
5609-15	6	.139	.212	.304	.038	.072
5609-13	6	.140	.180	.320	.020	.080
5609-2	6	.143	.180	.375	.020	.060
5609-9	6	.144	.196	.500	.050	.070
5609-3	6	.149	.185	.375	.025	.065
5609-17	6	.164	.225	.315	.034	.087
5609-18	8	.172	.260	.375	.025	.060
5609-21	10	.194	.251	.379	.032	.067
5609-22	10	.196	.248	.625	.050	.070
5609-25	12	.230	.296	.360	.026	.075
5609-26		.257	.308	.938	.050	.070
5609-28		.262	.340	.518	.025	.082
5609-30		.295	.380	.560	.022	.080
5609-27		.317	.370	.500	.032	.064
5609-29		.343	.450	.645	.055	.089
5609-31		.380	.441	.624	.019	.079
5609-32		.387	.505	.626	.017	.058
5609-33		.400	.500	.745	.022	.082
5609-36		.519	.569	.799	.008	.052

NYLON SHOULDER WASHER

Custom Sizes Available . . . See Last Page of This Section

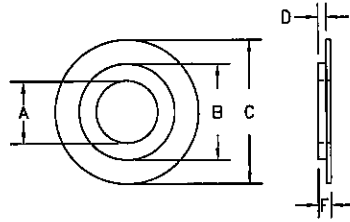

PART NUMBER	SCREW SIZE	A ± .005	B ± .010	C ± .010	D ± .005	F ± .015
5607-1	00	.046	.140	.187	.015	.030
5607-203	0	.063	.090	.250	.025	.056
5607-142	0	.063	.119	.187	.187	.218
5607-204	1	.085	.166	.201	.085	.125
5607-205	1	.087	.128	.180	.065	.094
5607-206	2	.090	.118	.187	.045	.075
5607-2	2	.090	.119	.187	.020	.050
5607-143	2	.090	.120	.187	.125	.172
5607-144	2	.090	.120	.187	.187	.234
5607-145	2	.090	.120	.187	.250	.297
5607-207	2	.090	.120	.235	.090	.137
5607-3	2	.090	.131	.187	.025	.094
5607-208	2	.091	.125	.312	.062	.125
5607-4	2	.093	.122	.250	.025	.056
5607-146	2	.093	.125	.205	.078	.110
5607-147	2	.093	.125	.205	.110	.141
5607-209	2	.093	.152	.250	.025	.056
5607-5	2	.093	.152	.312	.025	.056
5607-148	2	.093	.154	.250	.031	.062
5607-6	2	.094	.137	.250	.070	.106
5607-7	2	.097	.125	.187	.030	.090
5607-210	2	.097	.247	.505	.075	.127
5607-42	2	.098	.140	.250	.065	.095
5607-41	2	.098	.140	.250	.080	.112
5607-8	2	.098	.190	.250	.013	.058
5607-211	2	.100	.140	.250	.057	.157
5607-9	3	.110	.187	.250	.031	.062
5607-43	3	.112	.150	.250	.090	.140
5607-212	4	.114	.137	.215	.067	.100
5607-149	4	.114	.150	.312	.031	.110
5607-44	4	.114	.150	.312	.100	.145
5607-213	4	.115	.135	.235	.156	.203
5607-45	4	.115	.136	.200	.030	.060
5607-150	4	.115	.136	.240	.050	.112
5607-151	4	.115	.145	.235	.095	.140
5607-214	4	.115	.147	.235	.040	.087
5607-215	4	.115	.147	.235	.109	.171
5607-46	4	.115	.147	.235	.250	.296
5607-216	4	.115	.242	.375	.100	.140
5607-217	4	.116	.136	.230	.043	.190

Solder Lugs

Spring Clips

Spring Washers

Shoulder Washers

Stand Off Spacers

Flat Round Washers - Metallic

Flat Round Washers - Non-Metallic

O-Rings

Retaining Rings

Lockwashers, Retention Washers & Push-on Nuts

Clamps & Brackets

Expansion Plugs

Ground Straps, Bus Bars & Term. Blocks

Tab & Notch Washers

Misc. Washers & Tags

Solid State Insulators

Military Standards

Custom Parts

Engineering Tables

Num. & Alpha. Index of Parts

NYLON SHOULDER WASHER (Continued)

Custom Sizes Available . . . See Last Page of This Section

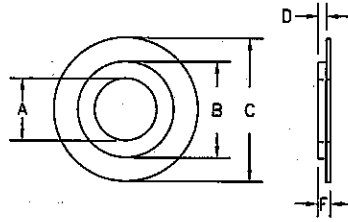

PART NUMBER	SCREW SIZE	A ± .005	B ± .010	C ± .010	D ± .005	F ± .015
5607-152	4	.116	.143	.210	.033	.075
5607-47	4	.116	.150	.250	.020	.050
5607-153	4	.116	.150	.250	.032	.095
5607-154	4	.116	.150	.250	.062	.093
5607-48	4	.116	.150	.250	.093	.153
5607-49	4	.116	.158	.316	.096	.148
5607-218	4	.116	.185	.312	.050	.112
5607-155	4	.116	.187	.250	.031	.062
5607-219	4	.117	.137	.250	.031	.094
5607-220	4	.117	.141	.281	.050	.145
5607-221	4	.117	.141	.281	.050	.180
5607-156	4	.118	.130	.250	.120	.170
5607-50	4	.118	.137	.250	.070	.106
5607-222	4	.118	.145	.240	.060	.110
5607-51	4	.118	.150	.250	.280	.326
5607-52	4	.118	.150	.250	.320	.366
5607-223	4	.118	.150	.312	.234	.284
5607-224	4	.120	.145	.200	.043	.068
5607-53	4	.120	.150	.250	.090	.140
5607-54	4	.120	.150	.250	.120	.175
5607-55	4	.120	.150	.250	.133	.180
5607-56	4	.120	.185	.250	.050	.081
5607-57	4	.120	.216	.375	.027	.058
5607-58	4	.120	.248	.625	.027	.089
5607-59	4	.121	.245	.375	.031	.094
5607-157	4	.121	.265	.375	.031	.094
5607-10	4	.123	.187	.312	.031	.094
5607-225	4	.125	.160	.250	.062	.125
5607-60	4	.125	.190	.375	.022	.062
5607-158	4	.125	.190	.375	.070	.110
5607-61	4	.125	.218	.312	.030	.062
5607-226	4	.125	.276	.330	.060	.120
5607-159	5	.126	.185	.312	.050	.081
5607-11	5	.126	.197	.312	.023	.053
5607-160	5	.126	.197	.312	.065	.100
5607-12	5	.126	.197	.312	.140	.170
5607-13	5	.128	.250	.375	.186	.250
5607-161	5	.130	.218	.343	.045	.090
5607-227	5	.132	.183	.308	.067	.112
5607-62	5	.136	.187	.250	.031	.093

NYLON SHOULDER WASHER (Continued)

Custom Sizes Available . . . See Last Page of This Section

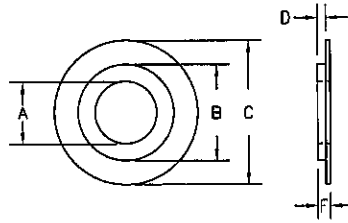

PART NUMBER	SCREW SIZE	A ± .005	B ± .010	C ± .010	D ± .005	F ± .015
5607-63	5	.136	.187	.312	.031	.093
5607-15	5	.136	.221	.312	.030	.067
5607-14	6	.139	.183	.312	.020	.082
5607-162	6	.140	.170	.290	.093	.140
5607-163	6	.140	.170	.290	.125	.172
5607-64	6	.140	.170	.290	.250	.295
5607-65	6	.140	.170	.290	.296	.343
5607-66	6	.140	.182	.320	.025	.094
5607-228	6	.140	.182	.320	.025	.111
5607-229	6	.140	.185	.250	.050	.110
5607-230	6	.140	.185	.290	.045	.135
5607-231	6	.140	.185	.375	.050	.112
5607-232	6	.140	.187	.234	.100	.150
5607-67	6	.140	.187	.312	.027	.062
5607-68	6	.140	.187	.312	.039	.062
5607-16	6	.140	.204	.328	.033	.092
5607-69	6	.140	.218	.375	.031	.078
5607-70	6	.140	.237	.375	.031	.093
5607-71	6	.141	.182	.320	.025	.094
5607-72	6	.141	.182	.320	.065	.115
5607-73	6	.141	.182	.320	.105	.174
5607-164	6	.141	.182	.320	.160	.232
5607-74	6	.141	.214	.375	.046	.086
5607-233	6	.141	.214	.375	.060	.100
5607-75	6	.141	.214	.375	.076	.116
5607-76	6	.141	.214	.375	.099	.139
5607-165	6	.141	.240	.500	.030	.093
5607-77	6	.141	.250	.375	.030	.090
5607-166	6	.141	.250	.468	.062	.112
5607-234	6	.143	.187	.313	.033	.066
5607-167	6	.144	.187	.250	.060	.090
5607-168	6	.144	.187	.312	.060	.090
5607-78	6	.144	.213	.310	.014	.035
5607-170	6	.145	.180	.255	.050	.112
5607-199	6	.145	.200	.290	.040	.087
5607-200	6	.145	.200	.290	.080	.127
5607-201	6	.145	.200	.290	.120	.167
5607-202	6	.145	.200	.290	.165	.212
5607-169	6	.145	.209	.380	.027	.058
5607-171	6	.145	.240	.375	.060	.090

Solder Lugs

Spring Clips

Spring Washers

Shoulder Washers

Stand Off Spacers

Flat Round Washers - Metallic

Flat Round Washers - Non-Metallic

O-Rings

Retaining Rings

Lockwashers, Retention Washers & Push-on Nuts

Clamps & Brackets

Expansion Plugs

Ground Straps, Bus Bars & Term. Blocks

Tab & Notch Washers

Misc. Washers & Tags

Solid State Insulators

Military Standards

Custom Parts

Engineering Tables

Num. & Alpha. Index of Parts

NYLON SHOULDER WASHER (Continued)

Custom Sizes Available . . . See Last Page of This Section

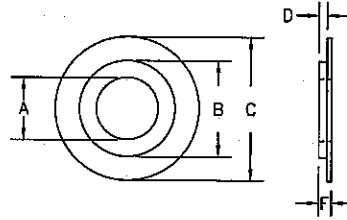

PART NUMBER	SCREW SIZE	A ± .005	B ± .010	C ± .010	D ± .005	F ± .015
5607-79	6	.147	.187	.375	.032	.094
5607-80	6	.150	.250	.375	.030	.087
5607-81	6	.155	.245	.360	.090	.130
5607-82	6	.155	.245	.375	.050	.100
5607-83	6	.160	.250	.375	.010	.052
5607-17	6	.163	.229	.312	.050	.096
5607-84	6	.166	.268	.500	.158	.219
5607-85	8	.169	.245	.440	.026	.089
5607-86	8	.169	.250	.380	.050	.080
5607-18	8	.169	.258	.375	.030	.067
5607-172	8	.170	.205	.344	.140	.200
5607-173	8	.170	.205	.344	.250	.312
5607-19	8	.170	.205	.344	.375	.437
5607-87	8	.170	.245	.390	.025	.094
5607-174	8	.171	.216	.437	.027	.089
5607-175	8	.171	.243	.375	.031	.062
5607-176	8	.171	.243	.500	.031	.062
5607-235	8	.171	.248	.625	.050	.112
5607-88	8	.171	.250	.375	.046	.086
5607-89	8	.171	.250	.375	.076	.116
5607-90	8	.171	.250	.375	.099	.139
5607-91	8	.174	.250	.375	.030	.093
5607-177	8	.175	.235	.344	.040	.103
5607-178	8	.175	.235	.344	.080	.143
5607-179	8	.175	.235	.344	.120	.183
5607-180	8	.175	.235	.344	.165	.228
5607-182	8	.175	.250	.375	.045	.125
5607-181	8	.176	.211	.319	.027	.058
5607-236	8	.176	.243	.380	.050	.081
5607-237	8	.186	.236	.340	.183	.225
5607-238	8	.187	.363	.750	.036	.112
5607-183	10	.190	.250	.380	.030	.096
5607-92	10	.193	.246	.500	.030	.064
5607-20	10	.193	.257	.375	.032	.065
5607-21	10	.193	.257	.375	.043	.078
5607-239	10	.193	.284	.498	.375	.500
5607-93	10	.193	.300	.450	.046	.086
5607-94	10	.193	.300	.450	.076	.116
5607-95	10	.193	.300	.450	.099	.139
5607-96	10	.193	.312	.440	.043	.137

NYLON SHOULDER WASHER (Continued)

Custom Sizes Available . . . See Last Page of This Section

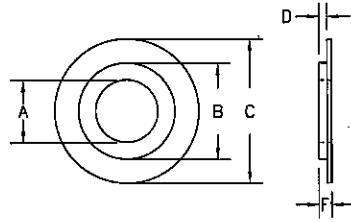

PART NUMBER	SCREW SIZE	A ± .005	B ± .010	C ± .010	D ± .005	F ± .015
5607-184	10	.193	.312	.750	.066	.163
5607-97	10	.195	.310	.625	.062	.093
5607-240	10	.196	.242	.375	.060	.180
5607-98	10	.196	.250	.312	.031	.062
5607-241	10	.196	.250	.312	.080	.100
5607-99	10	.196	.254	.380	.055	.120
5607-185	10	.196	.254	.380	.125	.190
5607-100	10	.196	.300	.500	.158	.278
5607-101	10	.196	.300	.581	.158	.278
5607-102	10	.196	.308	.375	.031	.093
5607-242	10	.197	.380	.625	.080	.140
5607-243	10	.198	.247	.750	.039	.114
5607-103	10	.199	.248	.500	.027	.058
5607-244	10	.199	.316	.500	.062	.172
5607-245	10	.199	.341	.500	.050	.112
5607-104	10	.199	.341	.750	.050	.112
5607-246	10	.199	.341	.750	.090	.152
5607-105	10	.200	.245	.530	.030	.070
5607-247	10	.200	.260	.350	.250	.312
5607-186	10	.200	.260	.399	.250	.312
5607-106	10	.200	.260	.399	.375	.437
5607-187	10	.200	.260	.399	.500	.562
5607-248	10	.200	.260	.400	.040	.103
5607-107	10	.200	.303	.390	.025	.094
5607-22	10	.200	.304	.375	.015	.072
5607-249	10	.203	.307	.438	.080	.174
5607-23	10	.203	.312	.438	.030	.094
5607-24	10	.203	.313	.390	.013	.104
5607-108	10	.204	.270	.500	.103	.150
5607-250	10	.204	.289	.435	.060	.156
5607-109	10	.206	.358	1.000	.031	.156
5607-110	10	.215	.380	.635	.090	.132
5607-251	12	.220	.435	.625	.153	.215
5607-25	12	.227	.300	.359	.046	.106
5607-188	12	.230	.250	.500	.280	.410
5607-252		.250	.310	.500	.065	.100
5607-26		.250	.312	.500	.031	.093
5607-27		.250	.343	.437	.156	.188
5607-253		.252	.271	.437	.013	.052
5607-254		.252	.343	.625	.062	.187

Solder Lugs

Spring Clips

Spring Washers

Shoulder Washers

Stand Off Spacers

Flat Round Washers - Metallic

Flat Round Washers - Non-Metallic

O-Rings

Retaining Rings

Lockwashers, Retention Washers & Push-on Nuts

Clamps & Brackets

Expansion Plugs

Ground Straps, Bus Bars & Term. Blocks

Tab & Notch Washers

Misc. Washers & Tags

Solid State Insulators

Military Standards

Custom Parts

Engineering Tables

Num. & Alpha. Index of Parts

NYLON SHOULDER WASHER (Continued)

Custom Sizes Available . . . See Last Page of This Section

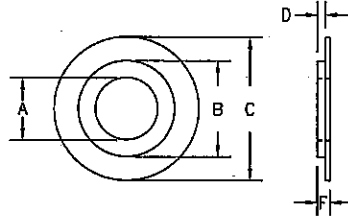

PART NUMBER	SCREW SIZE	A ± .005	B ± .010	C ± .010	D ± .005	F ± .015
5607-111		.253	.307	.438	.026	.120
5607-189		.253	.312	.375	.031	.093
5607-255		.255	.320	.500	.030	.099
5607-256		.255	.378	.630	.320	.382
5607-112		.257	.310	.750	.027	.058
5607-113		.257	.312	.560	.040	.100
5607-114		.257	.323	.420	.040	.075
5607-190		.258	.366	.755	.050	.081
5607-191		.260	.312	.513	.187	.250
5607-192		.260	.312	.513	.250	.312
5607-115		.260	.312	.513	.375	.437
5607-28		.260	.338	.515	.025	.089
5607-141		.260	.338	.515	.050	.089
5607-116		.260	.345	.516	.050	.110
5607-193		.260	.365	.500	.060	.090
5607-257		.260	.372	.515	.125	.250
5607-29		.260	.503	.750	.020	.086
5607-117		.265	.345	.500	.046	.086
5607-118		.265	.345	.500	.076	.116
5607-119		.265	.345	.500	.099	.139
5607-120		.265	.365	.500	.031	.093
5607-258		.265	.375	.687	.125	.188
5607-194		.265	.375	.750	.096	.218
5607-121		.266	.328	.625	.073	.120
5607-259		.268	.365	.760	.065	.130
5607-260		.270	.341	.750	.050	.112
5607-122		.280	.343	.437	.156	.188
5607-261		.280	.380	.500	.129	.380
5607-30		.290	.387	.562	.030	.079
5607-262		.310	.375	.450	.031	.062
5607-263		.312	.437	.750	.125	.200
5607-123		.315	.385	.500	.026	.120
5607-264		.317	.370	.750	.090	.210
5607-265		.318	.365	.500	.050	.080
5607-266		.318	.380	.665	.317	.355
5607-40		.318	.400	.562	.030	.060
5607-124		.321	.437	.750	.062	.125
5607-267		.323	.375	.750	.027	.081
5607-125		.323	.375	.750	.047	.094
5607-126		.327	.355	.750	.045	.094

NYLON SHOULDER WASHER (Continued)

Custom Sizes Available . . . See Last Page of This Section

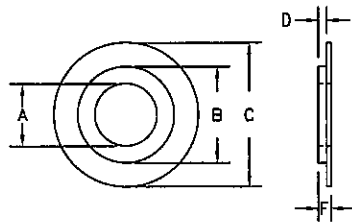

PART NUMBER	SCREW SIZE	A ± .005	B ± .010	C ± .010	D ± .005	F ± .015
5607-127		.328	.438	.562	.030	.098
5607-195		.351	.421	.620	.020	.060
5607-128		.358	.480	.750	.020	.040
5607-196		.375	.500	.625	.050	.400
5607-129		.375	.500	.750	.031	.093
5607-130		.375	.500	.750	.043	.105
5607-31		.378	.447	.625	.026	.087
5607-131		.378	.447	.625	.030	.060
5607-132		.380	.437	.625	.031	.062
5607-268		.380	.500	1.250	.280	.375
5607-269		.385	.450	.630	.031	.062
5607-270		.385	.495	.633	.025	.094
5607-133		.385	.495	.750	.020	.094
5607-32		.385	.505	.625	.013	.075
5607-134		.385	.505	.625	.031	.093
5607-271		.385	.625	.750	.125	.151
5607-33		.400	.503	.750	.024	.086
5607-34		.406	.500	.625	.031	.062
5607-35		.438	.600	.750	.085	.140
5607-135		.452	.562	.688	.030	.098
5607-136		.463	.506	.625	.095	.190
5607-272		.510	.620	.870	.190	.250
5607-36		.513	.572	.796	.017	.057
5607-37		.515	.556	.750	.050	.112
5607-38		.515	.556	1.000	.050	.112
5607-197		.515	.616	.875	.062	.089
5607-39		.515	.625	.750	.030	.098
5607-273		.515	.625	1.000	.125	.250
5607-137		.562	.687	.875	.094	.156
5607-198		.630	.860	1.250	.050	.100
5607-138		.680	.746	.875	.120	.150
5607-139		.750	.875	1.250	.024	.086
5607-140		.765	.875	1.250	.031	.125

Solder Lugs

Spring Clips

Spring Washers

Shoulder Washers

Stand Off Spacers

Flat Round Washers - Metallic

Flat Round Washers - Non-Metallic

O-Rings

Retaining Rings

Lockwashers, Retention Washers & Push-on Nuts

Clamps & Brackets

Expansion Plugs

Ground Straps, Bus Bars & Term. Blocks

Tab & Notch Washers

Misc. Washers & Tags

Solid State Insulators

Military Standards

Custom Parts

Engineering Tables

Num. & Alpha. Index of Parts

PHENOLIC GRADE (LE) SHOULDER WASHER

Custom Sizes Available . . . See Last Page of This Section

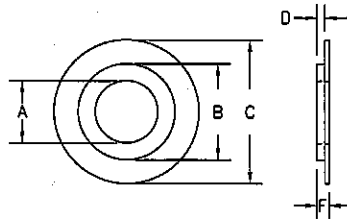

PART NUMBER	SCREW SIZE	A ± .005	B ± .010	C ± .010	D ± .005	F ± .015
5605-4	0	.070	.156	.250	.031	.062
5605-8	1	.080	.156	.250	.031	.062
5605-9	2	.089	.145	.200	.055	.090
5605-11	2	.090	.154	.225	.031	.090
5605-12	2	.094	.187	.312	.031	.062
5605-13	2	.099	.140	.375	.062	.109
5605-14	3	.101	.195	.312	.025	.110
5605-16	3	.105	.187	.312	.031	.062
5605-17	3	.105	.187	.312	.048	.093
5605-15	4	.115	.136	.200	.030	.060
5605-6	4	.115	.165	.200	.055	.090
5605-18	4	.115	.165	.312	.055	.093
5605-20	4	.120	.187	.312	.031	.062
5605-21	4	.125	.187	.250	.031	.062
5605-24	5	.132	.250	.375	.031	.062
5605-19	6	.140	.216	.437	.050	.081
5605-22	6	.140	.248	.437	.050	.081
5605-25	6	.145	.187	.310	.039	.062
5605-26	6	.146	.187	.250	.031	.093
5605-27	6	.146	.187	.312	.031	.093
5605-28	6	.148	.250	.375	.031	.062
5605-29	6	.150	.237	.375	.031	.093
5605-23	6	.157	.233	.437	.062	.125
5605-7	6	.159	.216	.314	.041	.100
5605-10	8	.170	.250	.375	.031	.093
5605-32	8	.174	.250	.375	.031	.062
5605-33	8	.175	.250	.375	.045	.125
5605-34	8	.182	.246	.375	.031	.093
5605-35	8	.190	.312	.625	.045	.096
5605-1	10	.200	.252	.375	.031	.064
5605-36	10	.200	.312	.500	.031	.062
5605-37	10	.200	.500	.875	.045	.093
5605-38	10	.200	.500	.925	.085	.285
5605-39	10	.206	.308	.375	.031	.093
5605-2		.250	.375	.500	.025	.075
5605-3		.253	.380	.510	.036	.093
5605-30		.258	.370	.562	.120	.180
5605-5		.260	.312	.500	.031	.062
5605-40		.260	.375	.500	.031	.062
5605-31		.260	.500	.925	.085	.200

PHENOLIC GRADE (LE) SHOULDER WASHER *(Continued)*

Custom Sizes Available . . . See Last Page of This Section

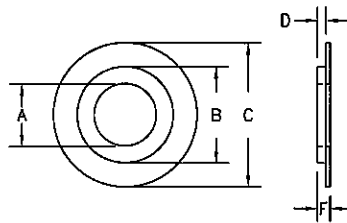

PART NUMBER	SCREW SIZE	A ± .005	B ± .010	C ± .010	D ± .005	F ± .015
5605-41		.275	.365	.500	.031	.093
5605-42		.319	.375	.500	.031	.094
5605-44		.320	.437	.625	.031	.062
5605-45		.380	.735	1.250	.025	.093
5605-48		.385	.500	.688	.031	.062
5605-49		.385	.500	.750	.031	.093
5605-50		.395	.500	.625	.031	.093
5605-52		.447	.625	.750	.031	.062
5605-53		.475	.550	.640	.030	.074
5605-54		.500	.750	1.000	.030	.063
5605-56		.510	.688	.875	.031	.062
5605-55		.510	.688	.875	.060	.200

Solder Lugs

Spring Clips

Spring Washers

Shoulder Washers

Stand Off Spacers

Flat Round Washers - Metallic

Flat Round Washers - Non-Metallic

D-Rings

Retaining Rings

Lockwashers, Retention Washers & Push-on Nuts

Clamps & Brackets

Expansion Plugs

Ground Straps, Bus Bars & Term. Blocks

Tab & Notch Washers

Misc. Washers & Tags

Solid State Insulators

Military Standards

Custom Parts

Engineering Tables

Num. & Alpha Index of Parts

TEFLON SHOULDER WASHER

Custom Sizes Available . . . See Last Page of This Section

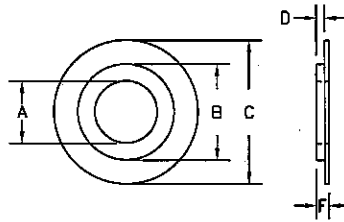

PART NUMBER	SCREW SIZE	A ±.005	B ±.010	C ±.010	D ±.005	F ±.015
5608-70	00	.048	.123	.156	.063	.152
5608-82	00	.060	.100	.400	.050	.084
5608-1	0	.063	.115	.200	.007	.038
5608-2	0	.073	.148	.172	.120	.160
5608-3	2	.090	.119	.190	.020	.050
5608-4	2	.090	.187	.320	.025	.094
5608-5	2	.091	.125	.312	.062	.125
5608-83	2	.093	.187	.281	.094	.187
5608-71	3	.100	.142	.250	.016	.059
5608-8	3	.100	.192	.250	.016	.059
5608-6	3	.101	.120	.203	.055	.070
5608-84	3	.110	.190	.290	.120	.210
5608-85	3	.112	.140	.250	.500	.625
5608-72	4	.115	.136	.200	.030	.060
5608-73	4	.116	.140	.250	.105	.137
5608-69	4	.116	.140	.250	.187	.233
5608-95	4	.116	.145	.240	.245	.292
5608-86	4	.116	.145	.250	.070	.200
5608-7	4	.116	.150	.250	.020	.050
5608-9	4	.118	.150	.250	.045	.091
5608-12	4	.118	.150	.250	.109	.154
5608-13	4	.120	.281	.375	.125	.185
5608-74	4	.125	.190	.375	.070	.110
5608-14	4	.125	.246	.562	.185	.243
5608-52	5	.128	.186	.312	.030	.055
5608-10	5	.128	.186	.312	.030	.094
5608-11	5	.128	.202	.328	.025	.051
5608-75	6	.139	.183	.312	.020	.082
5608-16	6	.139	.210	.328	.028	.088
5608-87	6	.140	.185	.562	.027	.089
5608-53	6	.140	.187	.312	.039	.062
5608-76	6	.140	.187	.500	.130	.250
5608-77	6	.140	.228	.312	.062	.096
5608-15	6	.140	.228	.312	.033	.065
5608-19	6	.140	.228	.312	.156	.199
5608-20	6	.142	.182	.320	.025	.094
5608-37	6	.142	.182	.320	.105	.174
5608-78	6	.142	.186	.312	.030	.080
5608-38	6	.145	.178	.313	.045	.094
5608-88	6	.145	.190	.348	.062	.112

TEFLON SHOULDER WASHER (Continued)

Custom Sizes Available . . . See Last Page of This Section

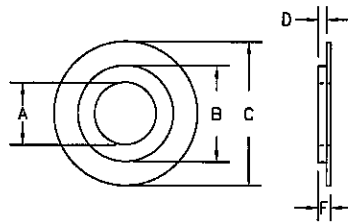

PART NUMBER	SCREW SIZE	A ± .005	B ± .010	C ± .010	D ± .005	F ± .015
5608-89	6	.145	.240	.375	.040	.090
5608-39	6	.145	.250	.375	.040	.090
5608-50	6	.147	.187	.312	.032	.093
5608-90	6	.155	.245	.375	.090	.130
5608-51	6	.156	.300	.500	.085	.250
5608-17	6	.163	.237	.312	.029	.084
5608-96	6	.166	.268	.500	.158	.219
5608-18	8	.168	.267	.375	.020	.056
5608-54	8	.169	.265	.375	.045	.094
5608-55	8	.170	.245	.391	.025	.094
5608-79	8	.176	.305	.567	.027	.058
5608-56	8	.187	.250	.625	.066	.120
5608-57	10	.193	.252	.375	.032	.064
5608-21	10	.194	.270	.375	.027	.063
5608-58	10	.194	.270	.375	.057	.086
5608-91	10	.195	.277	.500	.027	.090
5608-59	10	.195	.305	.495	.045	.094
5608-60	10	.200	.303	.390	.025	.094
5608-61	10	.204	.304	.375	.015	.045
5608-22	10	.204	.304	.375	.015	.060
5608-23	10	.205	.310	.377	.080	.125
5608-92	10	.210	.348	.625	.153	.231
5608-24	12	.219	.297	.562	.061	.093
5608-25	12	.231	.310	.375	.040	.083
5608-26	12	.234	.268	.375	.015	.097
5608-93		.250	.312	.875	.143	.168
5608-62		.250	.373	.500	.040	.060
5608-63		.250	.375	.625	.036	.090
5608-64		.257	.312	.560	.053	.087
5608-27		.260	.338	.508	.025	.094
5608-28		.260	.340	.531	.025	.075
5608-65		.260	.355	.545	.045	.094
5608-66		.266	.328	.750	.061	.093
5608-67		.281	.373	.500	.040	.060
5608-29		.291	.382	.562	.025	.065
5608-30		.295	.393	.562	.038	.091
5608-31		.317	.495	.688	.045	.094
5608-97		.320	.500	.690	.070	.115
5608-40		.324	.412	.562	.013	.061
5608-41		.327	.355	.750	.025	.094

- Solder Lugs
- Spring Clips
- Spring Washers
- Shoulder Washers**
- Stand Off Spacers
- Flat Round Washers - Metallic
- Flat Round Washers - Non-Metallic
- O-Rings
- Retaining Rings
- Lockwashers, Retention Washers & Push-on Nuts
- Clamps & Brackets
- Expansion Plugs
- Ground Straps, Bus Bars & Term. Blocks
- Tab & Notch Washers
- Misc. Washers & Tags
- Solid State Insulators
- Military Standards
- Custom Parts
- Engineering Tables
- Num. & Alpha. Index of Parts

TEFLON SHOULDER WASHER (Continued)

Custom Sizes Available . . . See Last Page of This Section

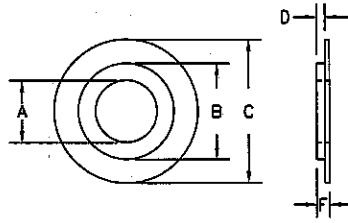

PART NUMBER	SCREW SIZE	A ± .005	B ± .010	C ± .010	D ± .005	F ± .015
5608-42		.327	.355	.750	.045	.114
5608-43		.330	.435	.500	.063	.172
5608-44		.350	.370	.705	.050	.074
5608-45		.350	.370	.705	.065	.104
5608-46		.385	.450	.630	.031	.062
5608-47		.385	.495	.633	.025	.094
5608-48		.390	.490	.750	.020	.094
5608-49		.390	.620	.812	.045	.094
5608-32		.395	.497	.625	.015	.060
5608-33		.408	.515	.750	.030	.090
5608-80		.500	.625	1.000	.054	.179
5608-34		.500	.625	1.000	.066	.120
5608-94		.500	.625	1.000	.125	.179
5608-81		.500	.665	1.005	.045	.115
5608-35		.505	.675	1.065	.045	.094
5608-36		.515	.575	.796	.016	.065
5608-68		.750	.875	1.000	.032	.064



NEED SOMETHING CUSTOM?

See our custom parts section beginning on page 539. Use our FAX quote cover sheet and blank print to design the exact part you need and fax it to us. We'll give it our immediate attention.

Seastrom[®]

MANUFACTURERS OF QUALITY CUSTOM AND STANDARD PARTS SINCE 1928

HOW TO REQUEST A FAX QUOTE:

CUSTOM SHOULDER WASHERS

If your application requires a custom shoulder washer with dimensions not listed in this catalog, simply photocopy the adjoining page, fill in all necessary dimensions, and fax it to us at 208-734-7222. It's that simple!

Seastrom Manufacturing can custom manufacture virtually any custom shoulder washer you require.*

For more information on materials — i.e. heat resistance, tensile strength, elasticity, etc., please refer to the engineering tables section.

EXAMPLE

A: <u>.171</u>	B: <u>.250</u>	C: <u>.375</u>	D: <u>.032</u>	F: <u>.063</u>
----------------	----------------	----------------	----------------	----------------

*If the configuration you require is different than shown on the adjoining page, please refer to the Custom Parts section for a fax quote cover sheet and a blank print to sketch your own design.

If we can answer any questions concerning your custom shoulder washer needs, please feel free to call us today at 1-800-634-2356.

FAX QUOTE

CUSTOM SHOULDER WASHERS

PLEASE FAX TO:

SEASTROM MANUFACTURING COMPANY, INC. 208•734•7222
ATTENTION: Inside Sales

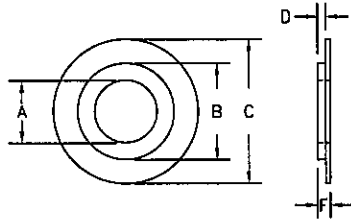

DATE _____

A: _____	B: _____	C: _____	D: _____	F: _____
----------	----------	----------	----------	----------

UNLESS OTHERWISE SPECIFIED ALL DIMENSIONS WILL BE TO CATALOG TOLERANCES.*

Material: _____

Other Requirements: _____

From: _____ Title: _____

Company: _____

Address: _____ City: _____ State: ____ Zip: _____

Phone: _____ Fax: _____

<p>Please Quote the following:</p>	<p><i>For Seastrom Use</i></p>	
QUANTITY	PRICE	DELIVERY
<p>Estimated Yearly Usage:</p>		

DO NOT TEAR OUT ... PLEASE PHOTOCOPY